

## NODE DOWNLIGHT USER MANUAL

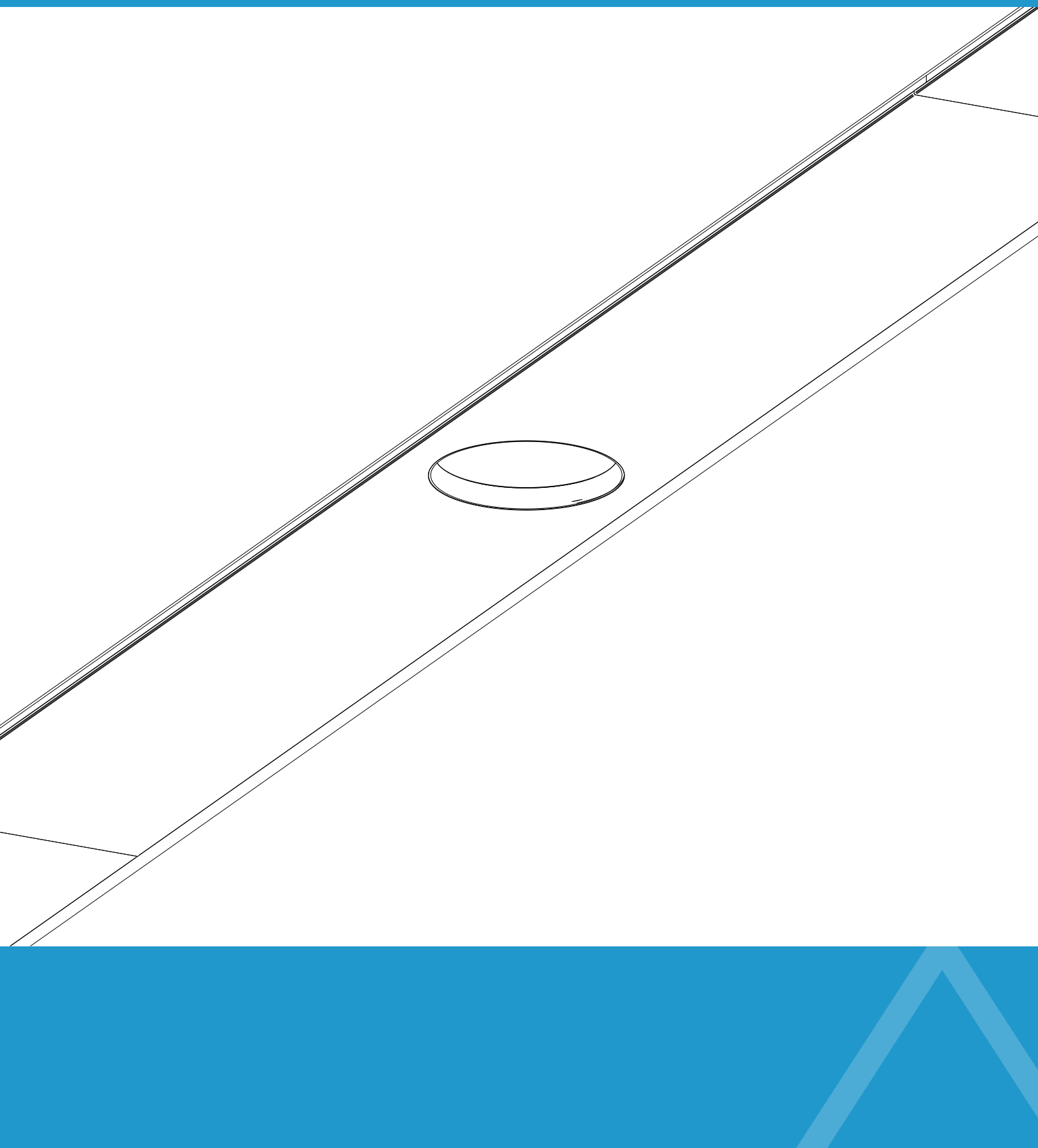

# 1 Safety Information

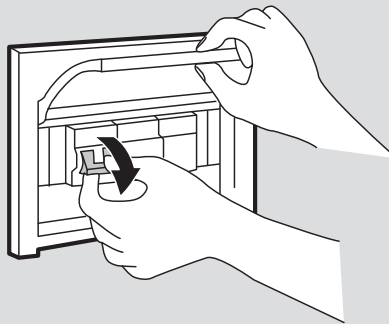
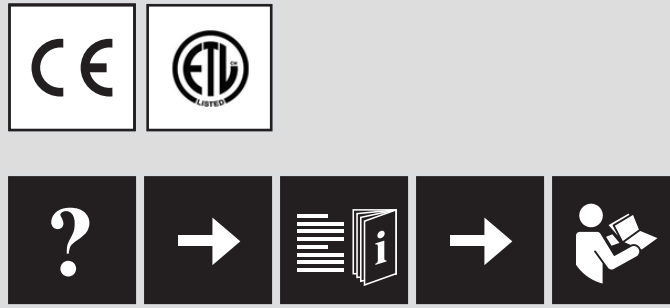

## 2 Required Parts

A) Recessed Channel

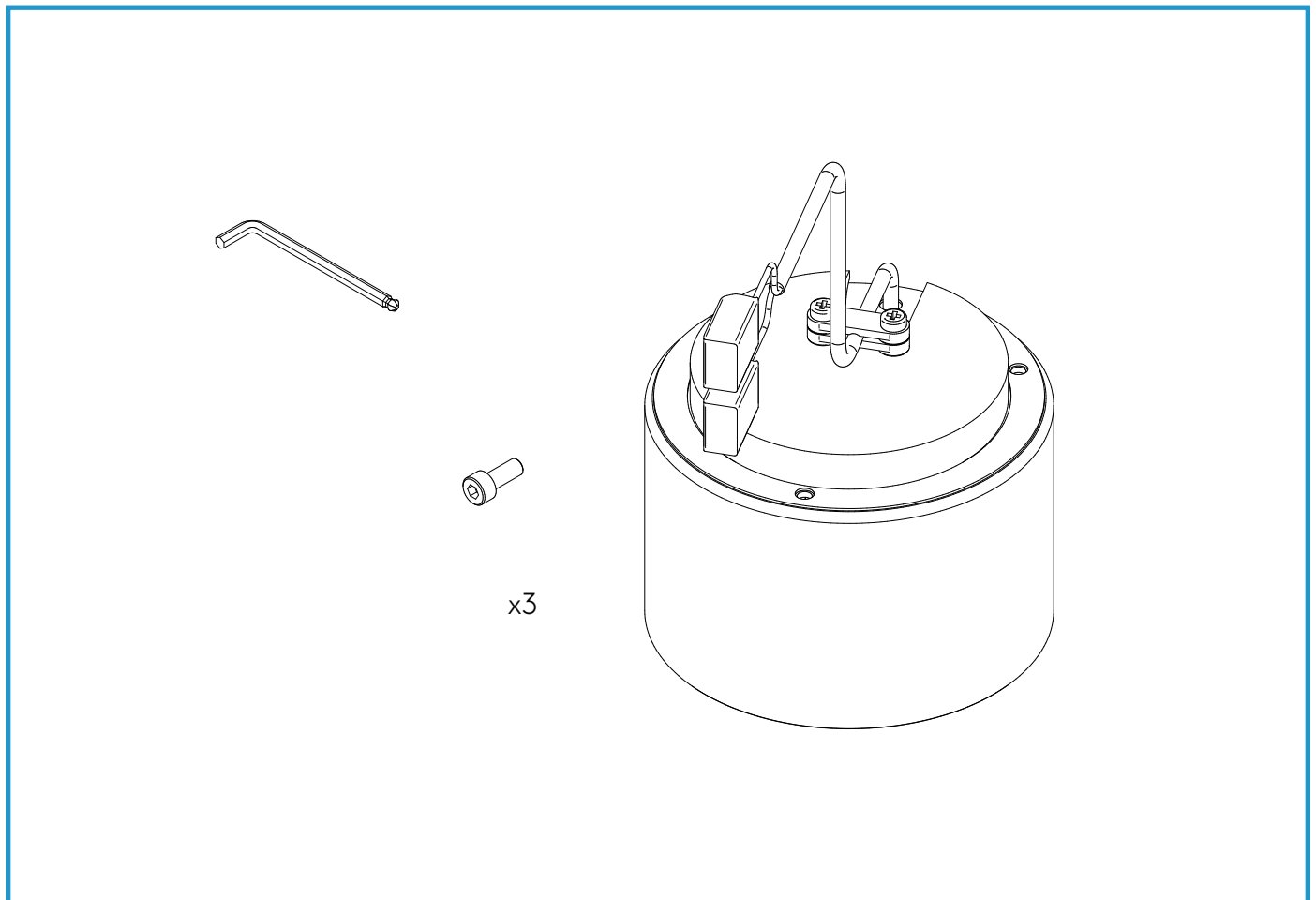

B) Trimless

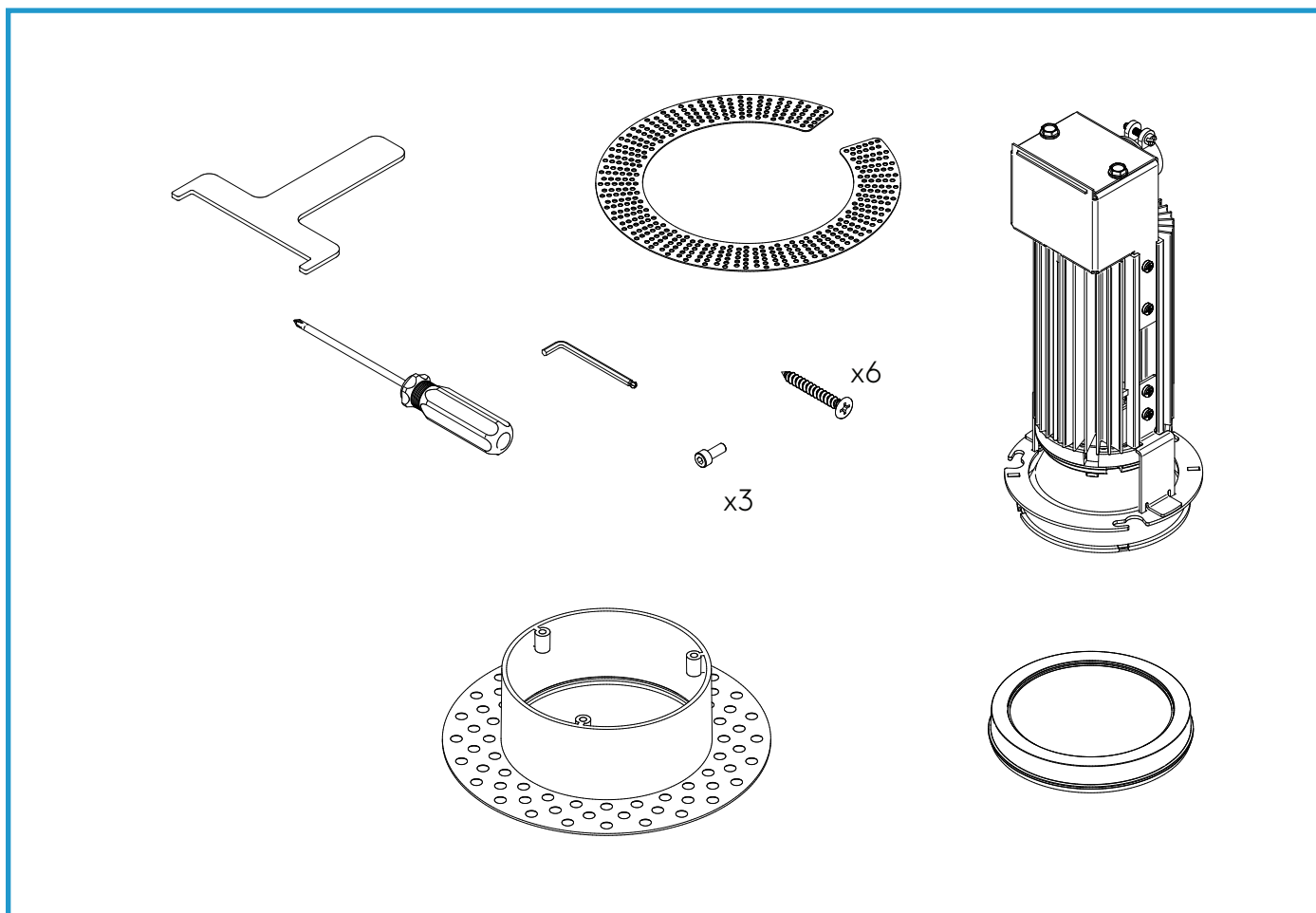

C) Flush Channel

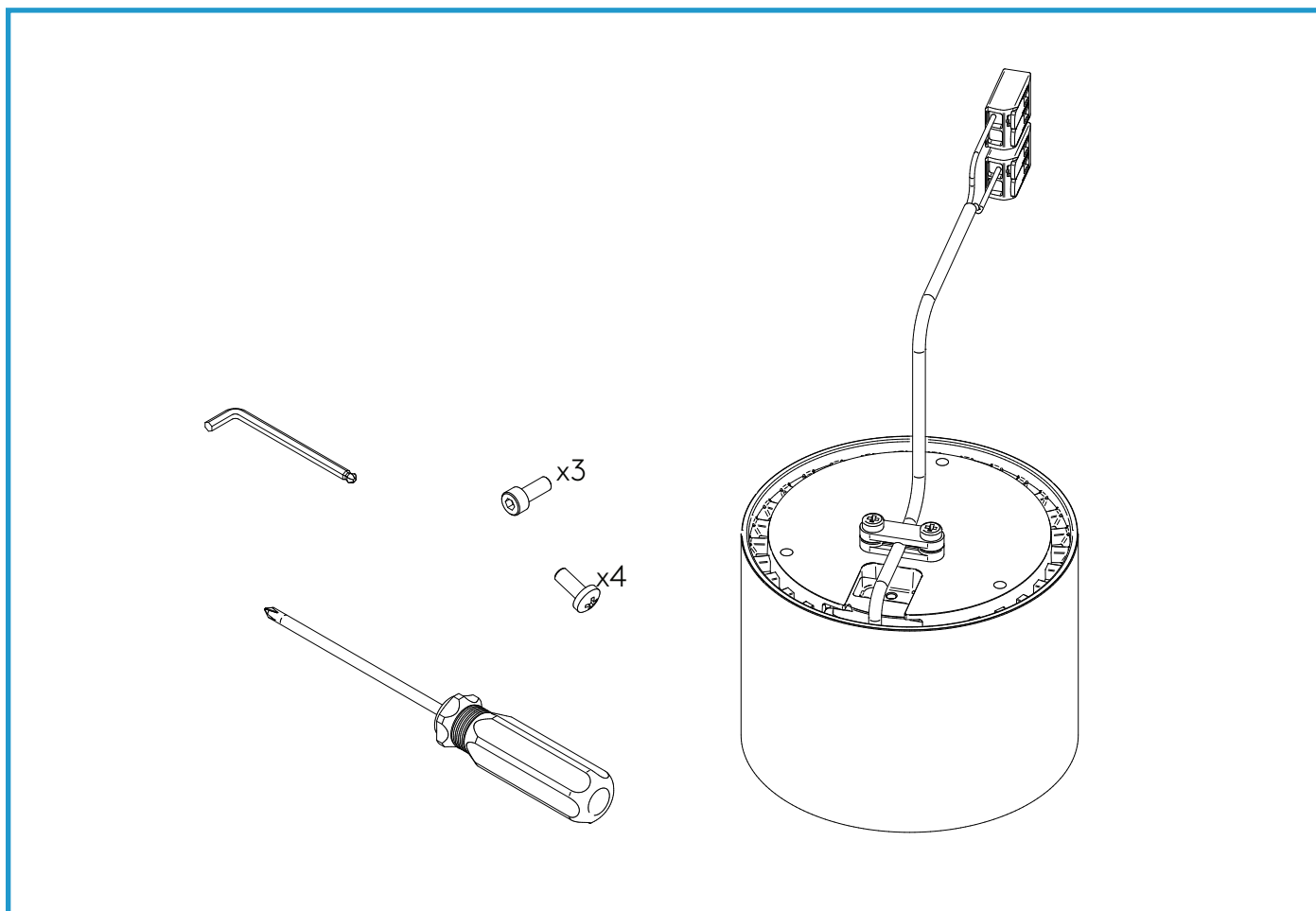

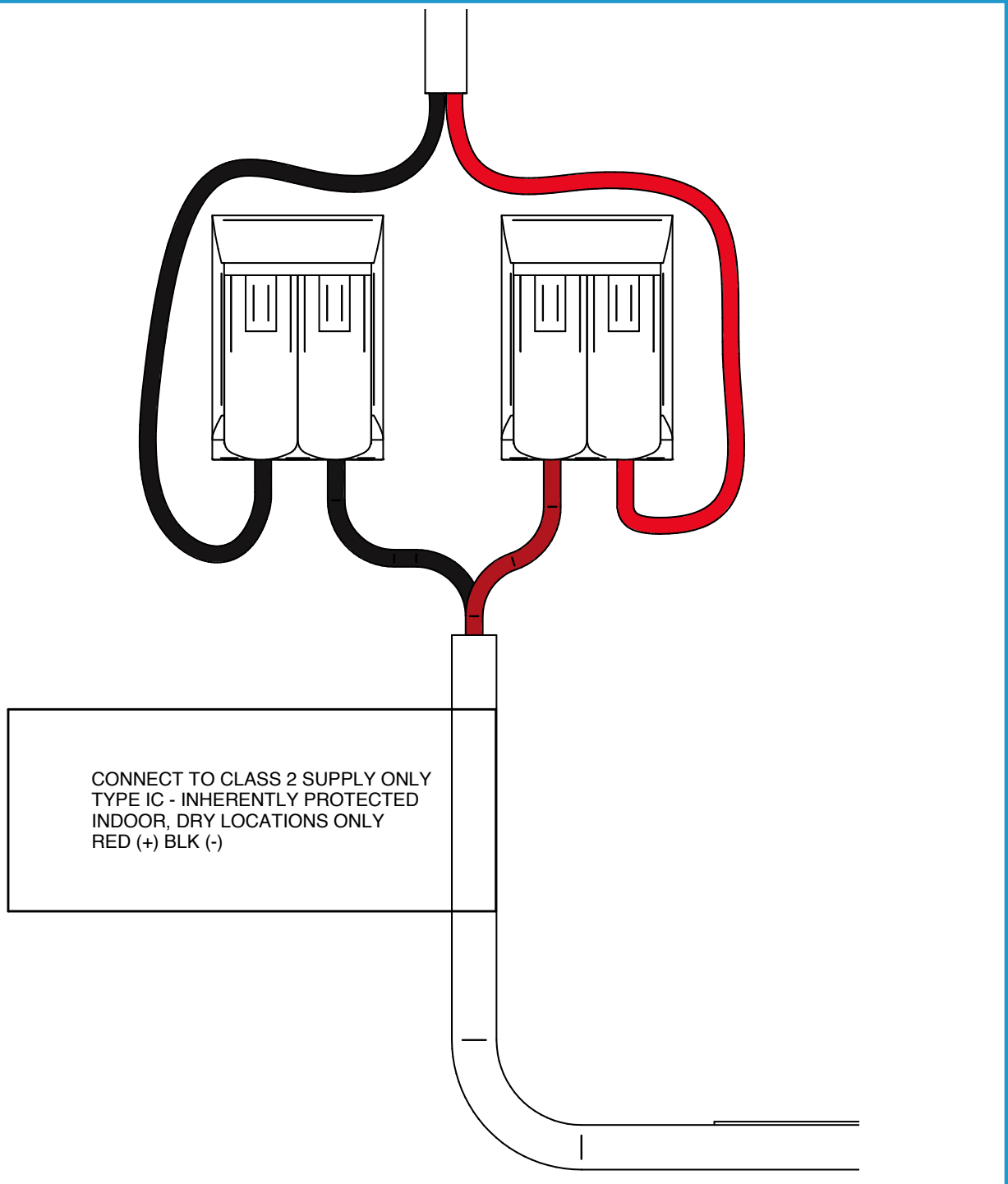

# 4

## Mounting Scenarios

### A) Recessed Channel Installation

1 of 4

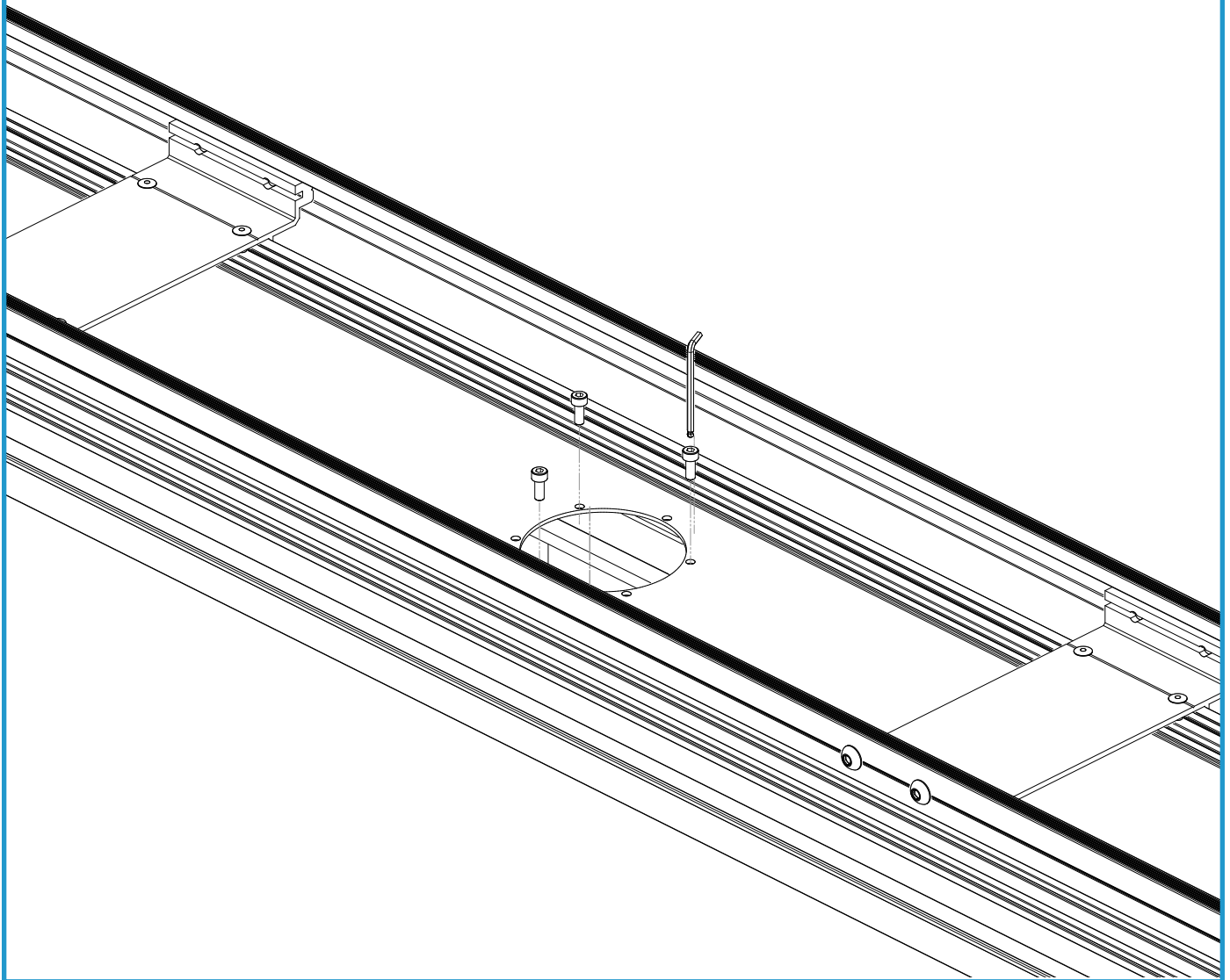

2 of 4

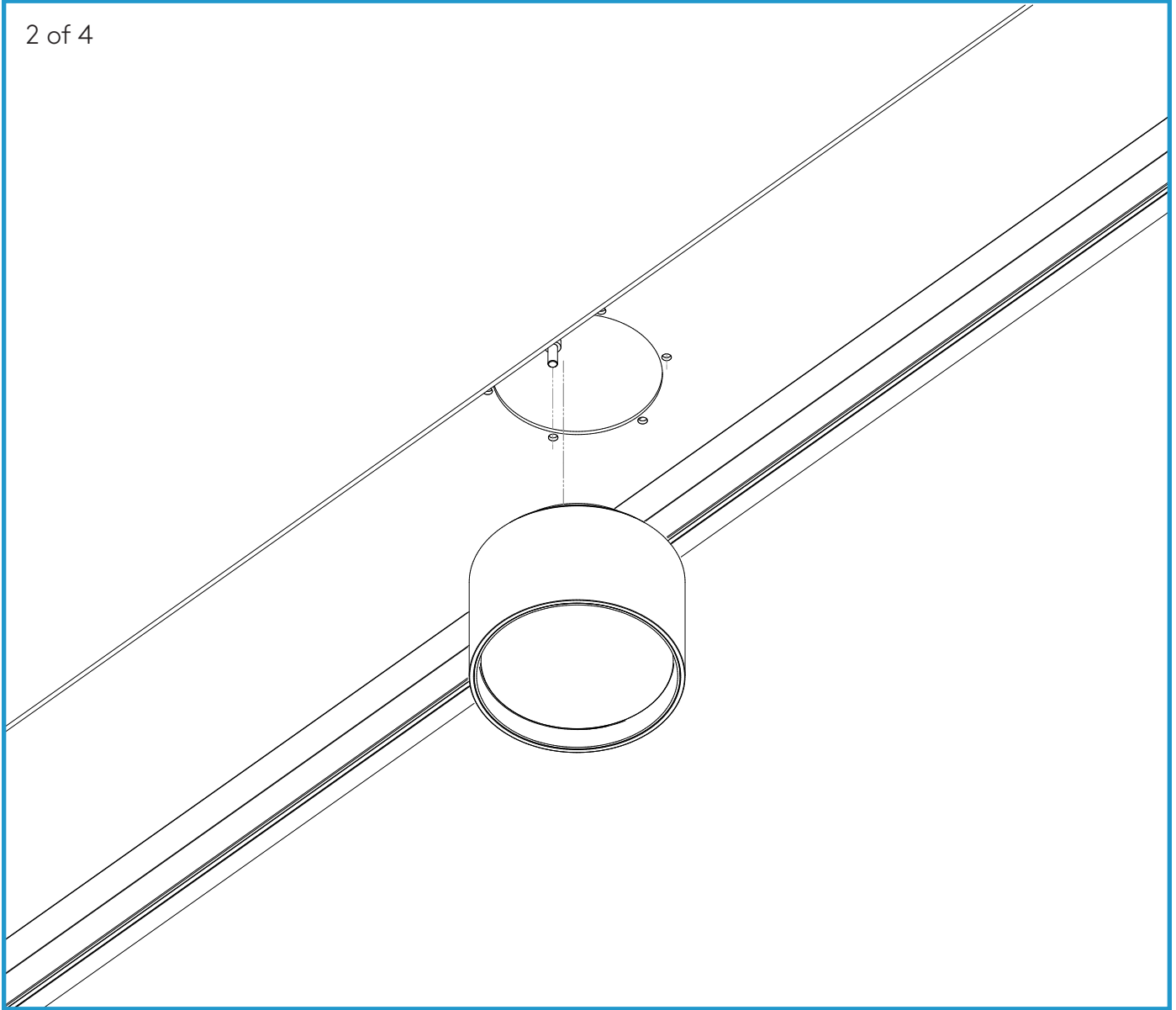



3 of 4

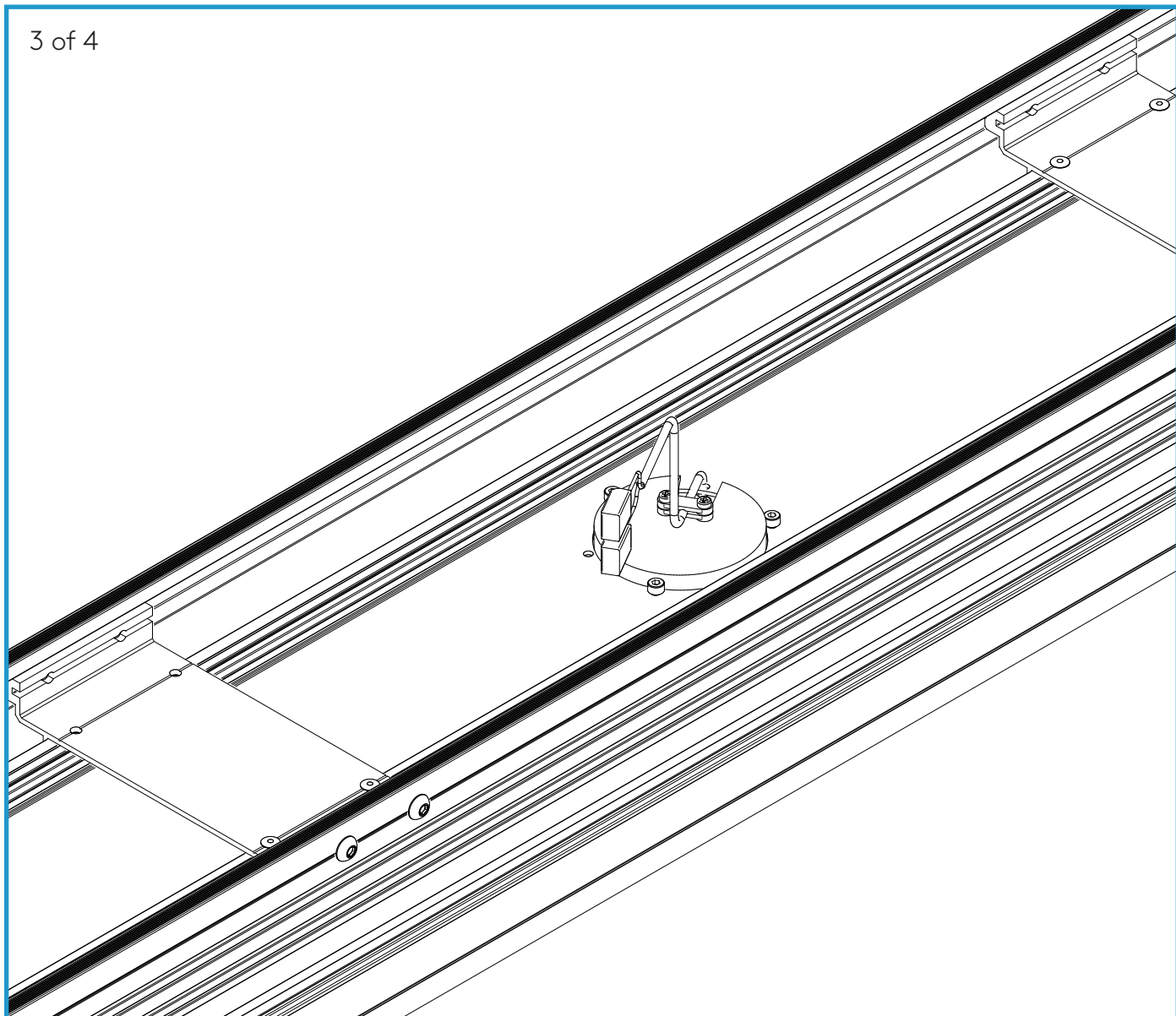

4 of 4

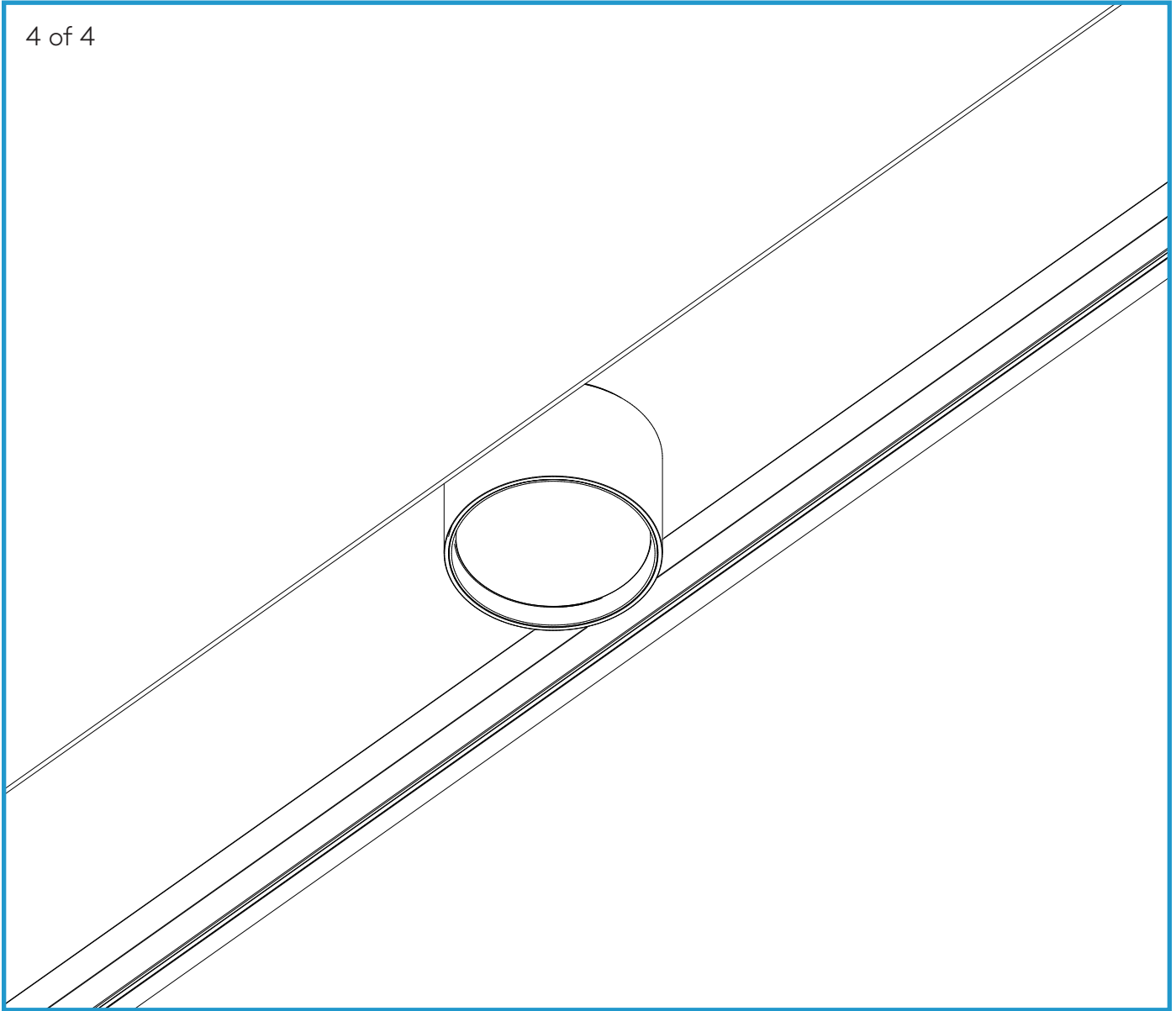

## 4 Mounting Scenarios

### B) Trimless Installation

1 of 14

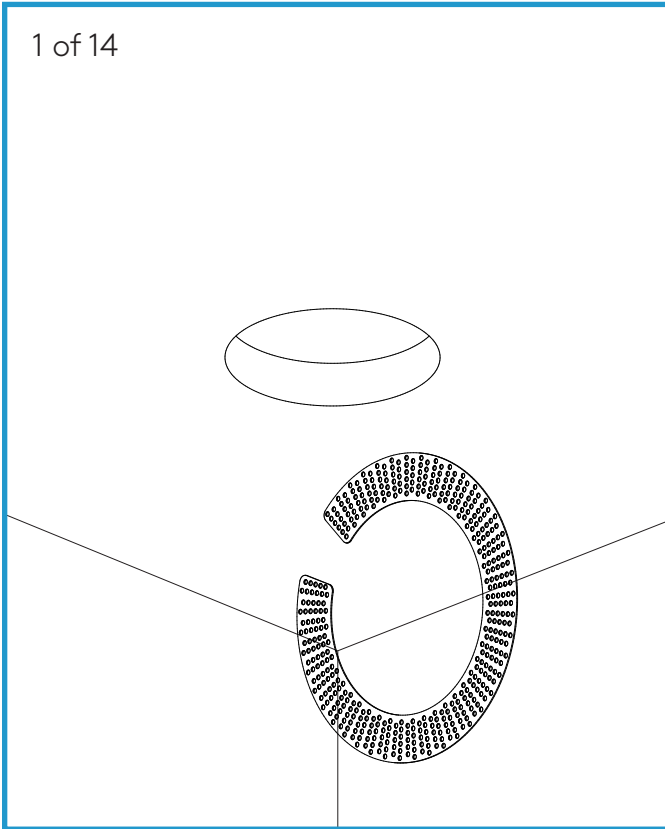

2 of 14

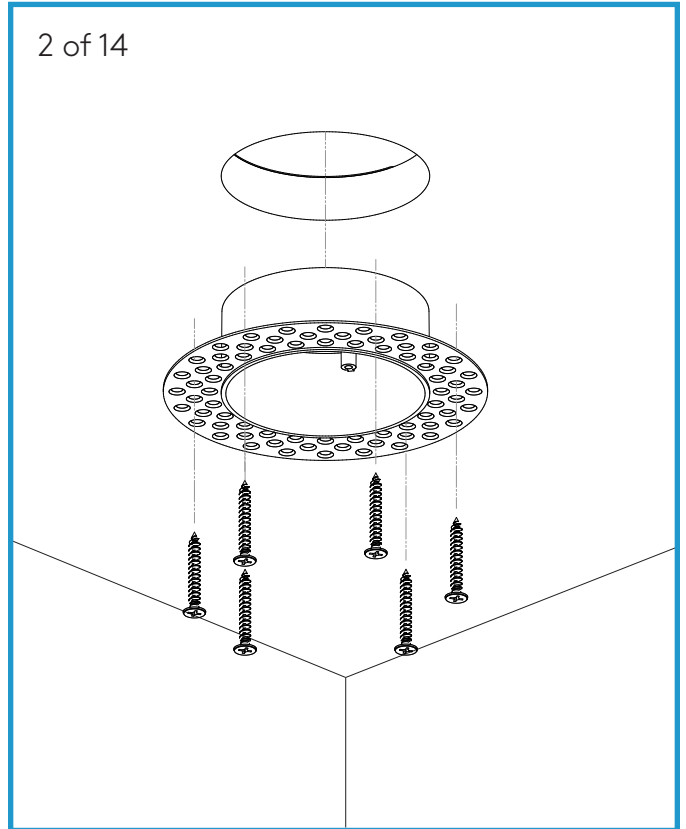

3 of 14

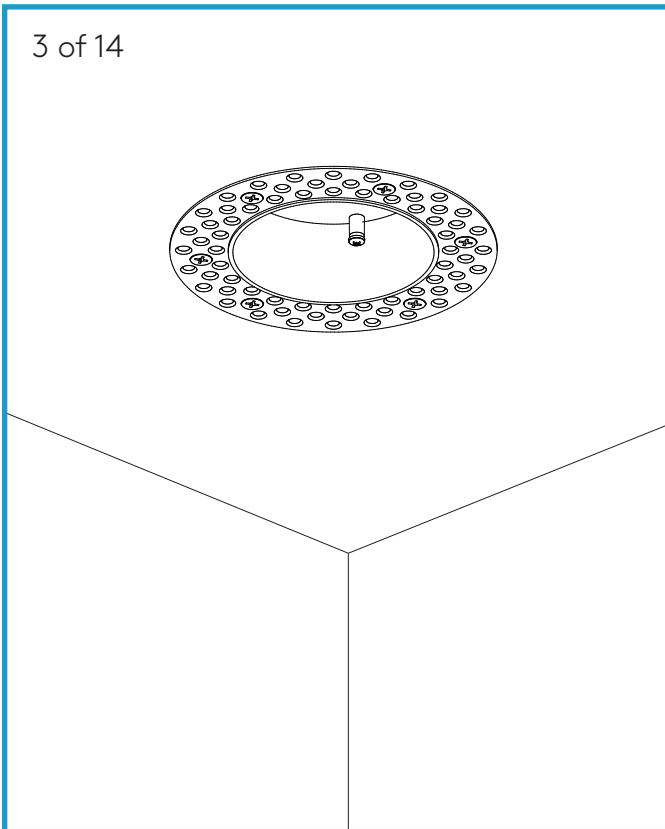

4 of 14

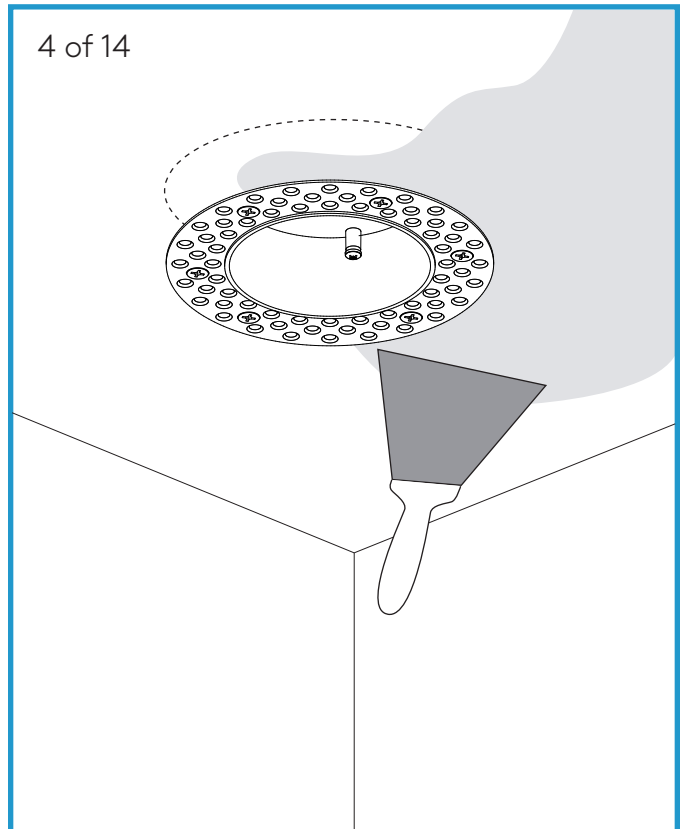

5 of 14

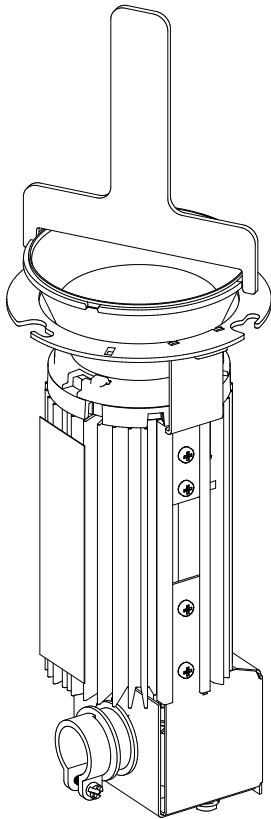

6 of 14

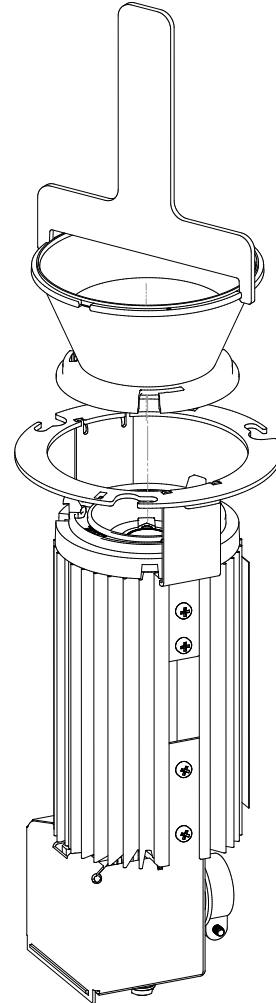

7 of 14

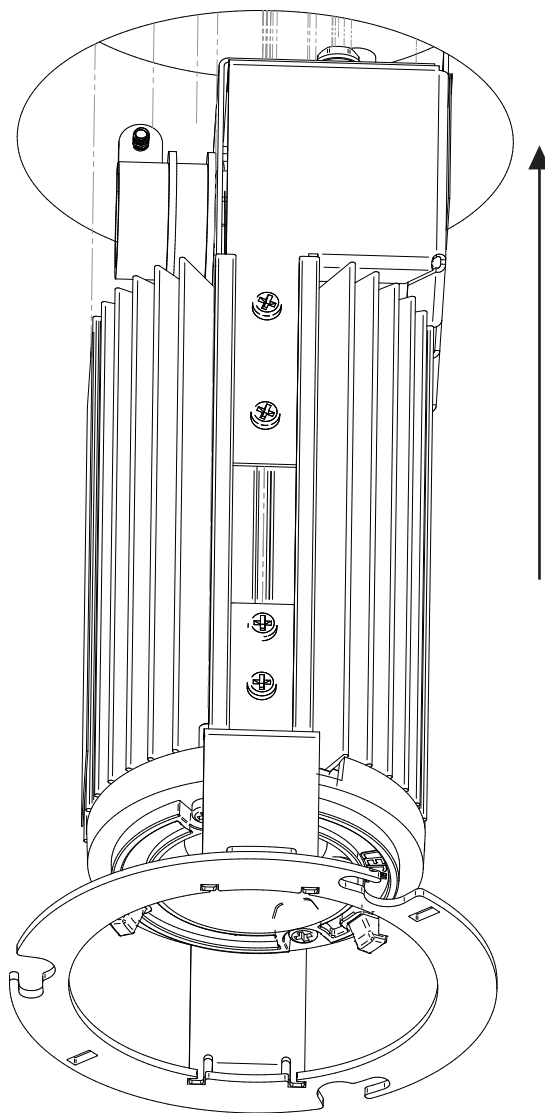

8 of 14

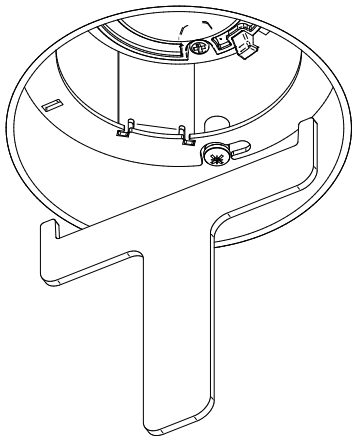

9 of 14

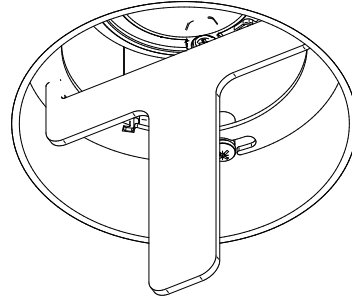

10 of 14

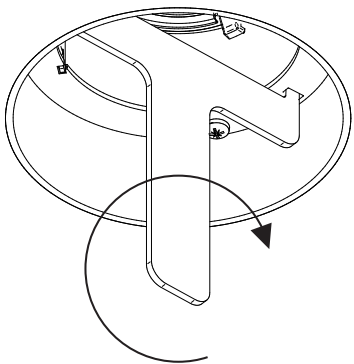

11 of 14

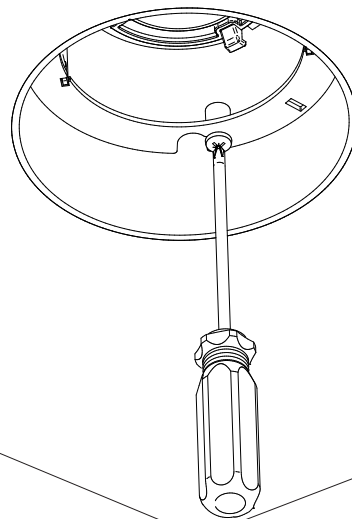

12 of 14

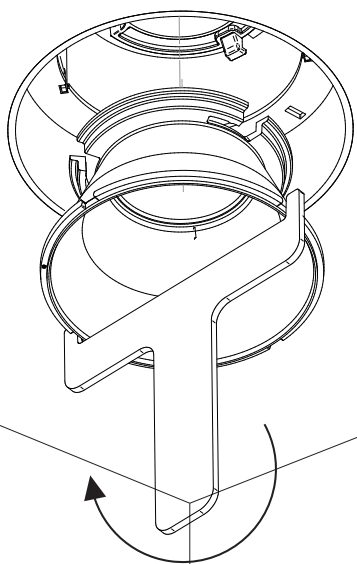

13 of 14

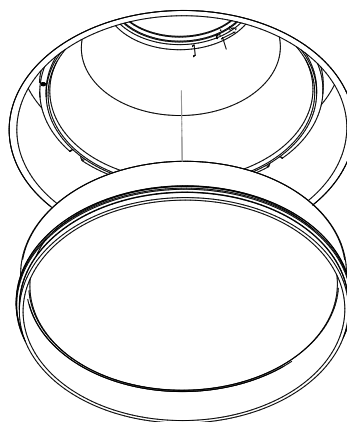

14 of 14

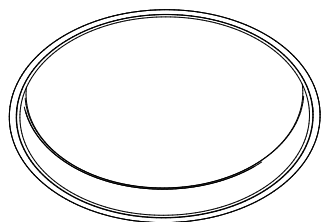

# 4

## Mounting Scenarios

### C) Flush Channel Installation

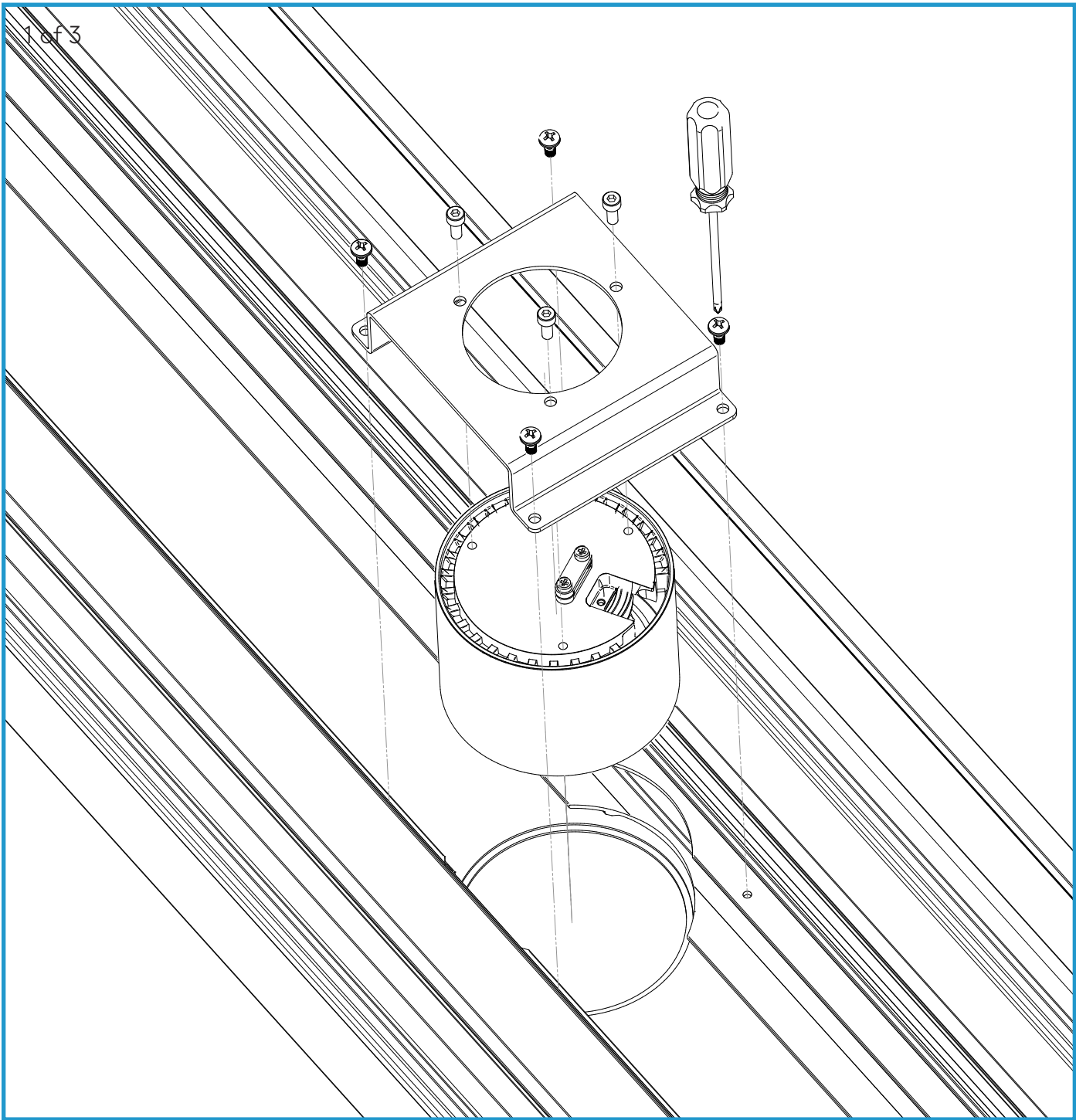



2 of 3

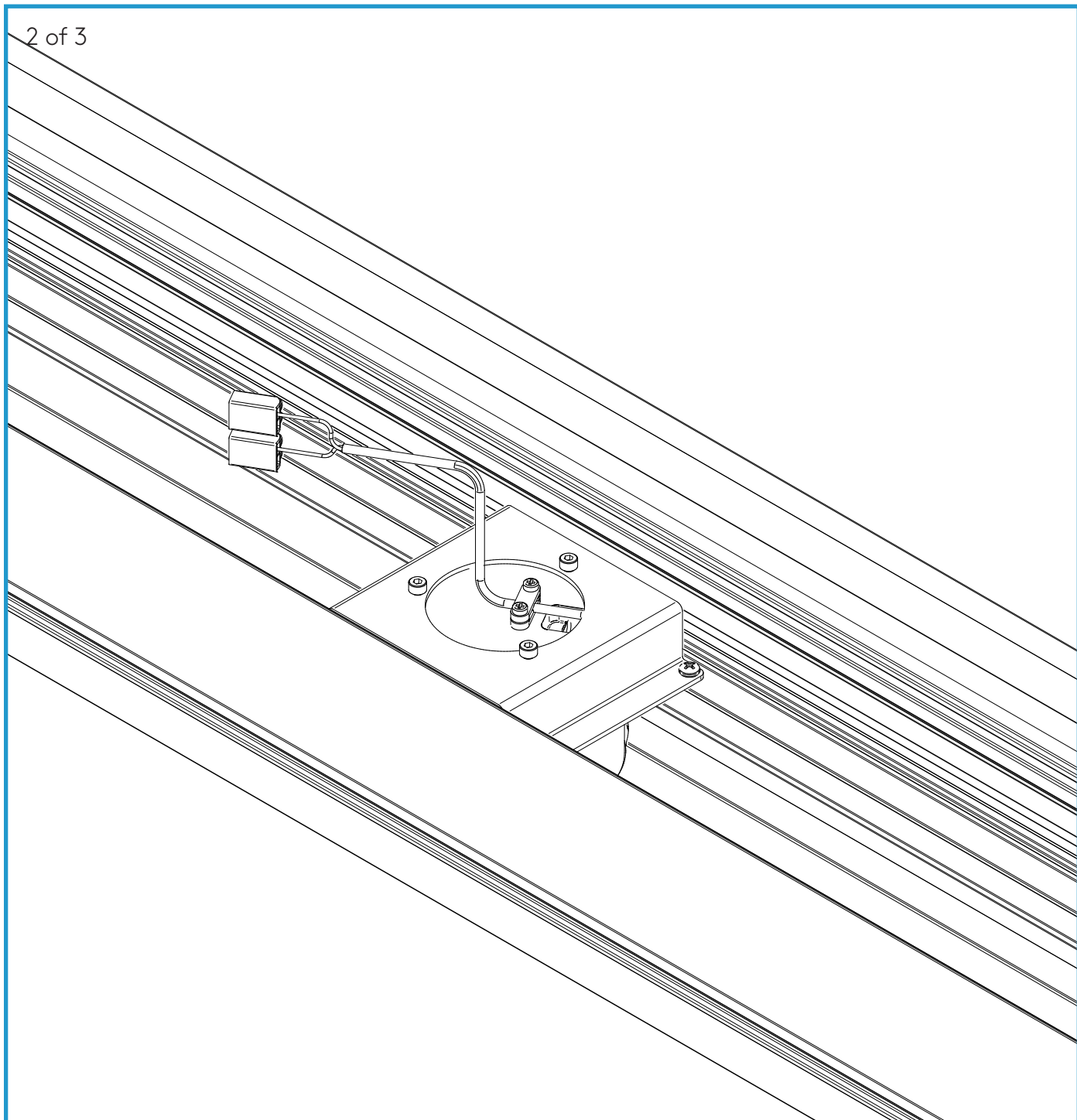

3 of 3

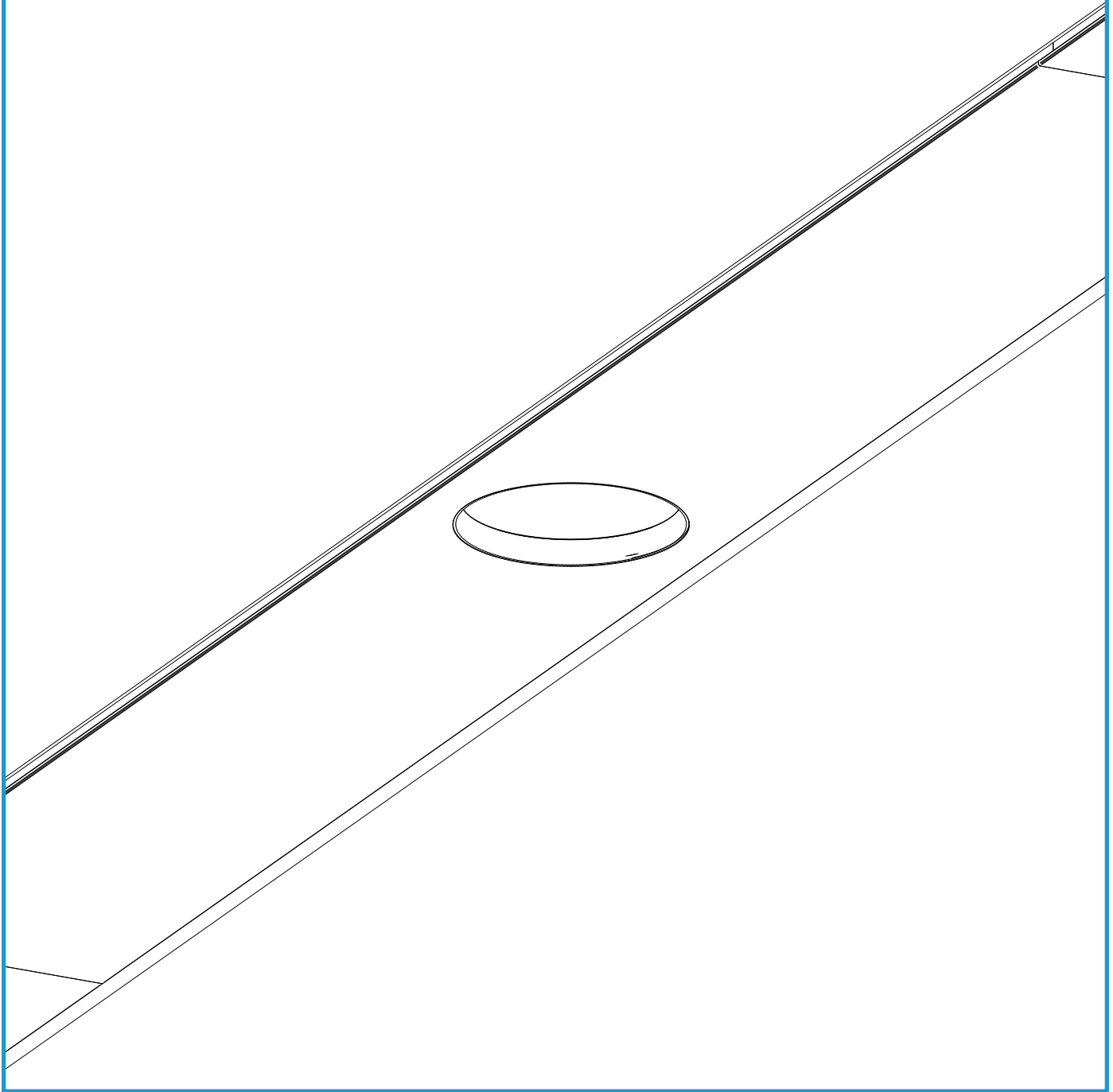

node

PARC<sup>®</sup>  
A Price Company